

Rio Dell Gateway Landscape Improvement Project

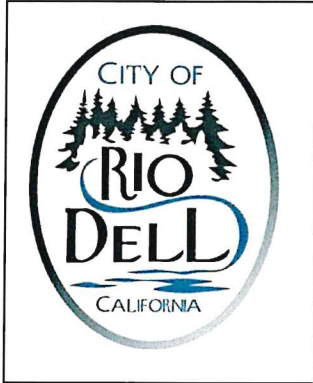

City of Rio Dell

Issued by Kyle
Knopp, City
Manager

[knoppk@cityofriodell.
ca.gov](mailto:knoppk@cityofriodell.ca.gov)

Issue Date: December 8, 2024

Due Date: January 8, 2024

Description: Grubbing, Excavation
and Planting, Irrigation Update

Addendum:

Summary: The City of Rio Dell is seeking bids for the Gateway Landscape Improvement Project, a component of the Clean California Initiative. The project includes grubbing, the excavation of existing soil materials with backfilling of new topsoil and installation of 114 Flowering Cherry Trees. The project also involves the replacement of 375 sprinkler heads with new water efficient rainbird sprinklers.

REQUIRED LICENSING:

Contractor has a "C-27" landscape contractor's license. **Contractor's License #**

_____ **Expires:** _____

Contractor has registered with the State of California's DIR (Department of Industrial Relations) website:

DIR Registration Number: _____

TIME OF COMPLETION:

Bidder agrees to complete the project on or before a date specified in a signed contract. The City desires to complete this project as soon as possible, no later than May 31st, 2024.

MANDATORY PRE-BID MEETING:

Bidders will not be required to attend a pre-bid meeting.

TIMELINE:

TIMELINE	DATES
RELEASE OF REQUEST FOR BID	December 8, 2024
MANDATORY PRE-BID MEETING ON:	N/A
WRITTEN QUESTIONS DUE	January 2, 2024 12:00pm
QUESTION RESPONSES POSTED	January 3, 2024 12:00pm
DEADLINE FOR BIDS TO BE RECEIVED	January 8, 2024 @ 10:00 am
	THE FOLLOWING DATES ARE TENTATIVE AND MAY BE SUBJECT TO CHANGE
OPENING OF SEALED BIDS	January 8, 2024 at 10:00am.
RECOMMENDATION OF AWARD TO CITY MANAGEMENT and/or COUNCIL	January 16, 2024
CONTRACT FINALIZATION / NEW CONTRACT START DATE	by January 19, 2024

Late, faxed, emailed, or unsigned bids will be rejected. Post marks do not count. No additional information or documentation will be accepted from proposers after the bid due date.

SCOPE OF SERVICES:

The project area is a section of Wildwood Avenue in Rio Dell California that stretches from Belleview Avenue in the north to Side Street in the south. The roadway's primary configuration include two traffic lanes separated by a 10' median and flanked on both sides by sidewalk grass and trees. Prior efforts to plant trees in the gateway were unsuccessful due to the mostly gravel composition of the ground just below the lawn.

This project seeks to correct these issues to create healthy trees in Rio Dell's "Gateway." One Hundred Fourteen (114) 15 Gallon Flowering Cherries are to be installed with the removal and replacement of approximately 125 cubic feet of soil per tree.

Work also includes the replacement of 375 sprinklers along the gateway.

Project Spoils Disposal site is indicated on Attachment D, at the corner of Ireland and Center Streets.

ENGINEER'S ESTIMATE

The Engineer's estimate for this project is \$125,535.00

TRAFFIC CONTROL SYSTEMS

The contractor will work in advance with the City to identify the necessary temporary street and sidewalk closure. In order to facilitate detours, the needed closures will be identified no less than 24 hours in advance.

SUBMISSION

All bids must be submitted in a sealed envelope clearly marked with the title of "Gateway Project"

- Late bids will not be accepted.
- Post marks do not count.
- All bids, whether selected or rejected, shall become the property of the City of Rio Dell.

Bids are to be sent to:

GATEWAY PROJECT
ATTN: CITY MANAGER
675 Wildwood Avenue
Rio Dell CA 95562

PREVAILING WAGE REQUIREMENT

Pursuant to the provisions of the Labor Code of the State of California, the Department of Industrial Relations has made a determination of the rate of per diem wages to be paid on the prevailing rate of pay for regular, holiday and overtime work in the locality in which the public work is to be performed, for each craft, classification, or type of workman needed to execute the contract. All City of Rio Dell projects greater than \$1,000 requires that contractors adhere to Prevailing Wage requirements (California Labor Code, Sections 1770 through 1775). The rates can be found online here:

<http://www.dir.ca.gov/OPRL/DPreWageDetermination.htm>

EXCEPTIONS TO SPECIFICATION

Bids taking the exception to any part or section of these specifications shall indicate such exceptions in the Bid. Failures to indicate any exceptions shall be interpreted as the Bid's

intent to fully comply with the specifications as written. However, conditional or qualified Bids are subject to rejecting in whole or in part.

EXPENSES INCURRED IN PREPARING THE BID

The city accepts no responsibility for any expense incurred by Bid in the preparation and presentation of a Bid, such expenses to be borne exclusively by the Bid.

BID INVESTIGATIONS

Before submitting a Bid, each Bid shall make all investigations and examinations necessary to ascertain the full performance of the contract and to verify any representations made by the city that the Bid will rely upon. No pleas of ignorance of such conditions and requirements resulting from failure to make such investigations and examinations will relieve the successful Bid from its obligation to comply with every detail of all provisions and requirements of the contract documents or will be accepted as a basis for any claim whatsoever for any monetary consideration on the part of the Bid.

QUALIFICATIONS OF BIDS

Each Bidder shall possess a valid C-27 License.

BID WITHDRAWAL

No Bid can be withdrawn after it is filed unless the Bid makes a request in writing to the city prior to the time set for the opening of Bids or unless the city fails to accept a Bid within ninety (90) days after the date fixed for opening Bids.

APPLICABLE LAW

The solicitation and any contract resulting from this solicitation shall be governed in all respects by the laws of the State of California and any litigation with respect thereto shall be brought in the courts of this State in the County of Humboldt. The successful Bid shall comply with all applicable federal, state, and local laws and regulations.

SELECTION PROCESS

The award of contracts shall be at the sole discretion of the City. Selection shall be based on the lowest responsive responsible bid received. The Bids should be submitted on the most favorable terms that the Bid can propose. It is the intent to make an award to one bid for all services required, although the City reserves the right to make multiple awards, depending on the needs and best interests of the City. The City may accept or reject any or all Bids in whole or in part and may waive informalities in the process. The contents of the Bid of the selected bid will become the basis for a contractual obligation when the award

is made.

Final contract award will be subject to approval by the City Council. The City reserves the right to award a contract or contracts to Contractor that presents a Bid which, in the sole judgment of the city, serves the best interest of the city.

The city reserves the right to reject any and all Bids, to waive minor irregularities in said Bids, or to negotiate deviations with the successful Bid.

CONFLICT OF INTEREST

Bid warrants and covenants that no official or employee of the city, nor any business entity in which an official of the city has an interest, has been employed or retained to solicit or assist in the procuring of the resulting contract, nor any such person will be employed in the performance of such contract without immediate divulgence of such fact to the city.

CONTRACT

If a Bid is accepted, the successful Bid will be required to sign a contract. Any executed contract will be substantially similar.

INSURANCE REQUIREMENTS:

See Attachment A.

ASSIGNMENT:

Any contract resulting from this Bid and any amendments or supplements shall not be assignable by the successful Bid.

RESERVATION OF RIGHTS:

The City of Rio Dell reserves the right to:

- Cancel this Request for Proposal
- Amend this Request for Proposal
- Extend the deadline for submissions
- Waive minor irregularities or failures to conform to the Request for Proposal

NEGOTIATIONS:

The city reserves the right to negotiate prior to contract execution with any Bid. Items

that may be negotiable include, but are not limited to, types and scope of services and activities, performance criteria, start date and project completion date. Negotiable items must be consistent with the original Bid submitted, including proposed costs. Bids may not change the terms of their Bid after bid opening.

INQUIRY:

City of Rio Dell
Attn: City Manager
675 Wildwood Avenue
Rio Dell, CA 95562

knoppk@cityofriodell.ca.gov

ATTACHMENTS:

- A. Insurance Requirements
- B. Bid Sheet
- C. Concept Image
- D. Spoils Disposal Location

EXHIBIT "A"

INSURANCE REQUIREMENTS

CONTRACTOR shall procure and maintain for the duration of the contract insurance against claims for injuries to persons or damages to property which may arise from or in connection with the performance of the work hereunder by the CONSULTANT, its agents, representatives, or employees.

1) MINIMUM SCOPE AND LIMITS OF INSURANCE

a) Commercial General Liability coverage (occurrence Form CG 00 01) with minimum limits of \$1,000,000 per occurrence for bodily injury, personal injury, products and completed operations, and property damage. If Commercial General Liability or other form with a general aggregate limit is used, either the general aggregate limit shall apply separately to this project/location or the general aggregate limit shall be twice the required occurrence limit.

b) Automobile Liability coverage (Form CA 00 01 with Code 1 – any auto) with minimum limits of \$1,000,000 per accident for bodily injury and property damage.

c) Workers' Compensation insurance as required by the State of California and Employers' Liability insurance, each in the amount of \$1,000,000 per accident for bodily injury or disease.

2) INDUSTRY SPECIFIC COVERAGES

If checked below, the following insurance is also required.

- Professional Liability Insurance / Errors and Omissions Liability in the minimum amount of \$1,000,000 per occurrence.
- Pollution Liability Insurance in the minimum amount of \$1,000,000 per occurrence
- Garage Keepers Insurance in the minimum amount of \$1,000,000 per occurrence
- Fidelity / Crime / Dishonesty Bond in the minimum amount of \$_____
- MCS-90 Endorsement to Business Automobile insurance for transportation of hazardous materials and pollutants
- Builder's Risk / Course of Construction Insurance in the minimum amount of \$_____.

3) INSURANCE PROVISIONS

a) DEDUCTIBLES AND SELF-INSURED RETENTIONS. Any deductibles or self-insured retentions must be declared to and approved by the CITY. At the option of the CITY, either the insurer shall reduce or eliminate such deductibles or self-insured retentions as respects the CITY, its officers, officials, employees and volunteers; or the CONSULTANT shall procure a bond guaranteeing payment of losses and related investigations, claim administration and defense expenses.

b) The general and automobile liability policies (and if applicable, pollution liability, garage keepers liability and builder's risk policies) are to contain, or be endorsed to contain, the following provisions:

- i) The CITY, its officers, officials, employees and volunteers are to be covered as insureds as respects: liability arising out of work or operations performed by or on behalf of the CONSULTANT; products and completed operations of the CONSULTANT; premises owned, occupied or used by the CONSULTANT; and automobiles owned, leased, hired or borrowed by the CONSULTANT. The coverage shall contain no special limitations on the scope of protection afforded to the CITY, its officers, officials, employees or volunteers.
 - ii) For any claims related to this project, the CONSULTANT'S insurance coverage shall be primary insurance as respects the CITY, its officers, officials, employees and volunteers. Any insurance or self-insured maintained by the CITY, its officers, officials, employees or volunteers shall be excess of the CONSULTANT'S insurance and shall not contribute with it.
 - iii) Any failure to comply with reporting or other provisions of the policies including breaches of warranties shall not affect coverage provided to the CITY, its officers, officials, employees or volunteers.
 - iv) The CONSULTANT'S insurance shall apply separately to each insured against whom claim is made or suit is brought, except with respect to the limits of the insurer's liability.
 - v) Each insurance policy required by this clause shall be endorsed to state that coverage shall not be suspended, voided, canceled by either party, reduced in coverage or in limits except after thirty (30) days' prior written notice by certified mail, return receipt requested, has been given to the CITY.
 - vi) The policy limits of coverage shall be made available to the full limits of the policy. The minimum limits stated above shall not serve to reduce the CONSULTANT'S policy limits of coverage. Therefore, the requirements for coverage and limits shall be (1) the minimum coverage and limits specified in this agreement, or (2) the broader coverage and maximum limits of coverage of any insurance policy or proceeds available to the named insured, whichever is greater.
- c) ACCEPTABILITY OF INSURER. Insurance is to be placed with insurers with a current A.M. Best's rating of no less than A:VII, unless otherwise acceptable to the CITY.

VERIFICATION OF COVERAGE. CONSULTANT shall furnish the CITY with original endorsements effecting coverage required by this Exhibit D. The endorsements are to be signed by a person authorized by that insurer to bind coverage on its behalf; on forms equivalent to CG 20 10 11 85, subject to CITY approval; and submitted electronically through the Exigis insurance system to: certificates-fairfield@riskworks.com. All insurance certificates and endorsements are to be received and approved by the CITY before work commences. At the request of the CITY, CONSULTANT shall provide complete, certified copies of all required insurance policies, including endorsements effecting the coverage required by these specifications.

d) SUB-CONTRACTORS. CONSULTANT shall require all subcontractors to procure and maintain insurance policies subject to the requirements of Exhibit D. Failure of CONSULTANT to verify existence of sub-contractor's insurance shall not relieve CONSULTANT from any claim arising from sub-contractors work on behalf of CONSULTANT.

Attachment B

Rio Dell Bid Schedule: Gateway Planting & Irrigation

Item Code	Description	Unit	Quantity	Unit Price	Amount
170103	Clearing and Grubbing	LS	1	\$	\$
204099	Plant Establishment Work	LS	1	\$	\$
202006	Soil Amendment	CY	12	\$	\$
210110	Imported Topsoil	CY	316	\$	\$
202038	Packet Fertilizer	EA	114	\$	\$
204038	Plant (Group U) - 45 Pink Flowering Cherries 15 Gallon; 69 White Flowering Cherries 15 Gallon.	EA	114	\$	\$
210212	Dry Seed	SQFT	2850	\$	\$
210610	Compost	CY	23	\$	\$
210630	Incorporate Materials	SQFT	2850	\$	\$
208221 (F)	3/4" Drip Irrigation Tubing	LF	635	\$	\$
208448	Riser Sprinkler Assembly - 192 6" Rainbird 325A; 183 6" Rainbird 1806APPRS.	EA	375	\$	\$
TOTAL					\$

Exhibit C

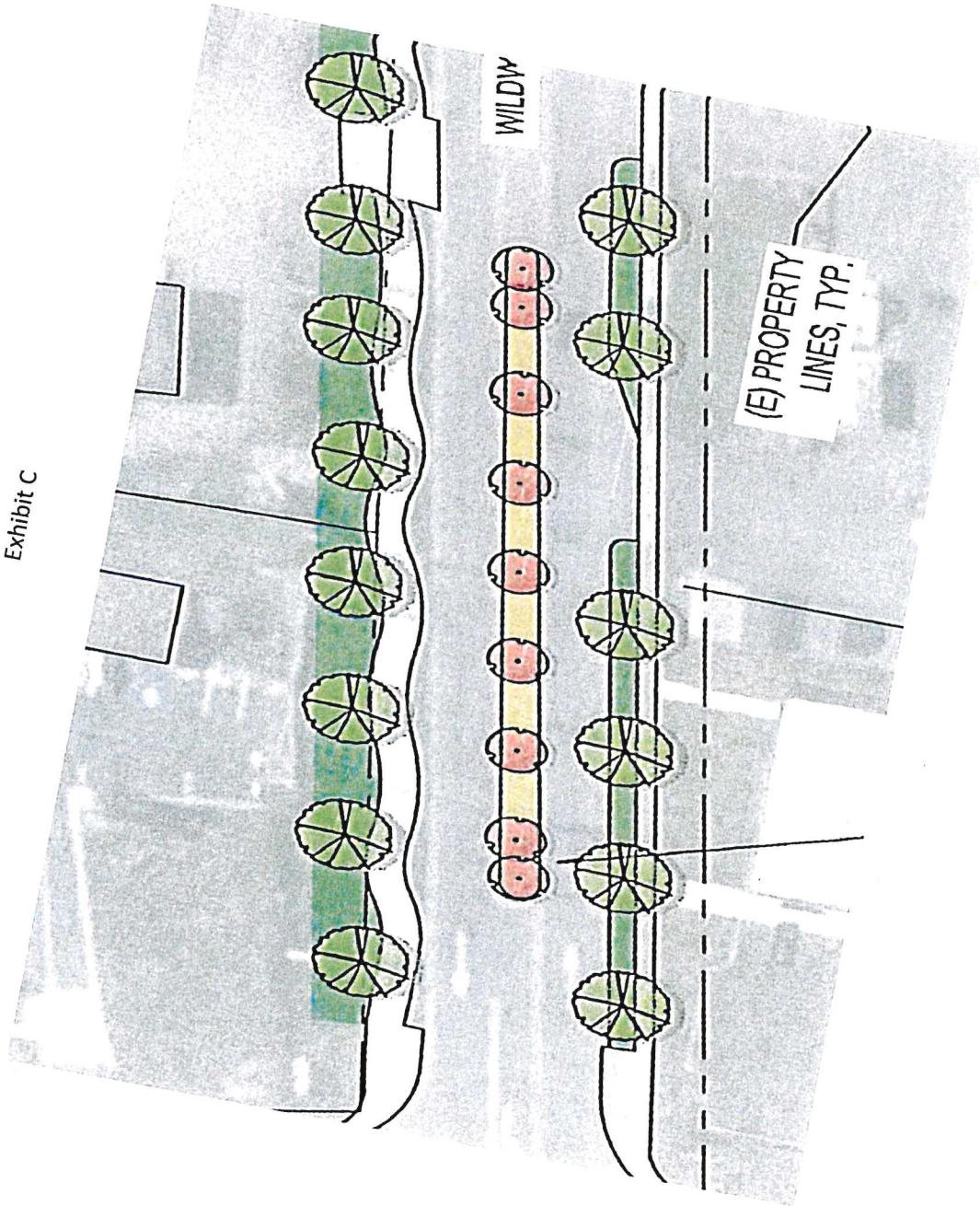

Spoils Disposal

ATTACHMENT D

Legend



Widewood Waffles

Google Earth